

VIVID SPOTLIGHT SERIES

INSTALLATION INSTRUCTION



IP66

IK08

220-240V

5 YRS
Warranty

3-60
WATTS

+/- 90°

360°

Upon request

0-10V

DALI

DMX

RGBW

PHYSICAL	
Body	High corrosion resistance die-cast copper-free aluminum body
Finish	Powder coated with phosphocromating pre-finish Textured grey, Anthracite grey, Matt black, Bronze
Screws	Stainless steel
Gasket	Silicone rubber
OPTICAL	
Diffuser	Tempered Glass
Beam angle	18°,24°,36°,60°,40x70°
Aiming	Rotatable with accessories
CCT	2700K/3000K/4000K/5000K/RGBW
CRI	>80
SDCM	McAdam step 3
ELECTRICAL	
Light source	LED
Efficacy	90 lm/W
Driver	Integrated LED driver 220-240V 50/60Hz
Power cable	0.5 mt. neoprene power cable included
Ambient Temp.	-25°C - 50°C
Ambient Humidity	10% - 90%

CAUTION: BEFORE CONNECTING THE FIXTURE TO A POWER SUPPLY MAKE SURE THE POWER IS SWITCHED OFF.

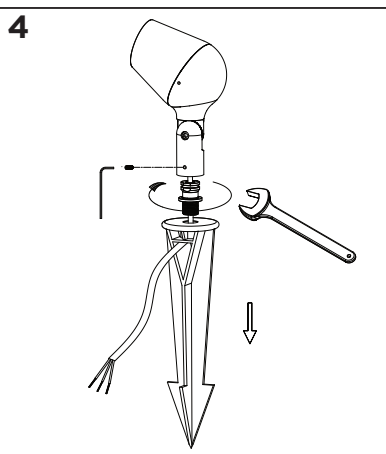
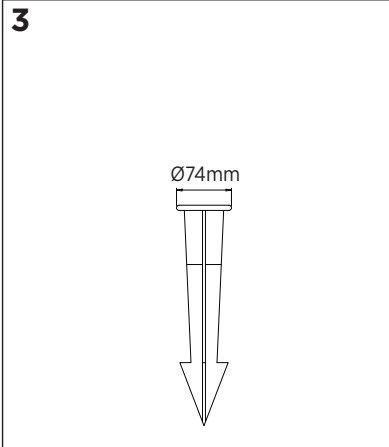
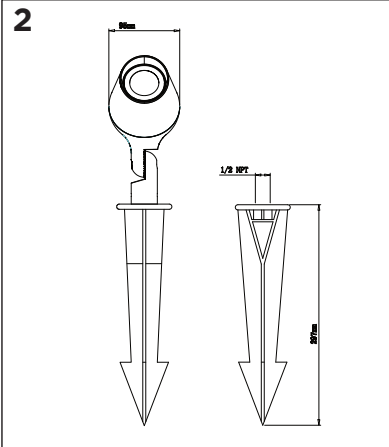
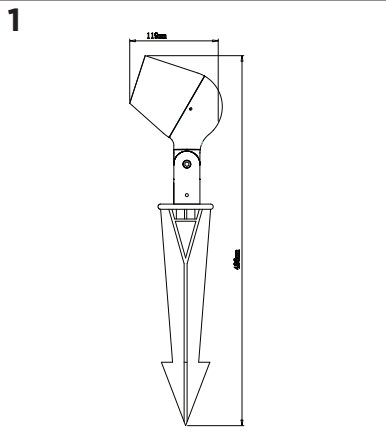

Mounting Knuckle to J-Box

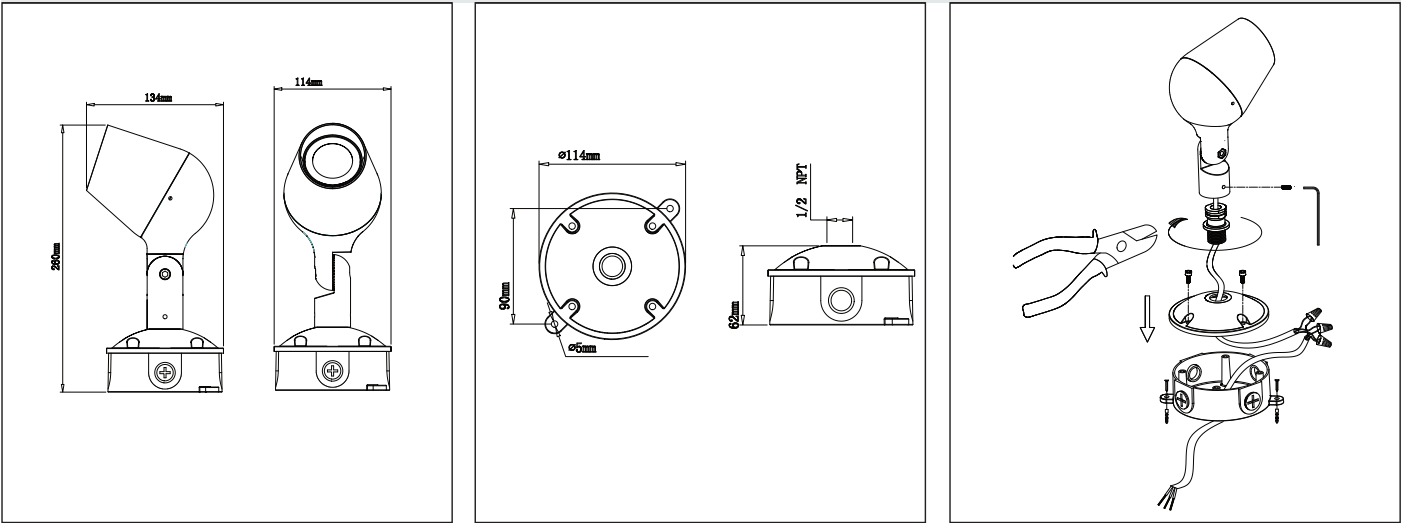

Direct Round Pole Wall Mount

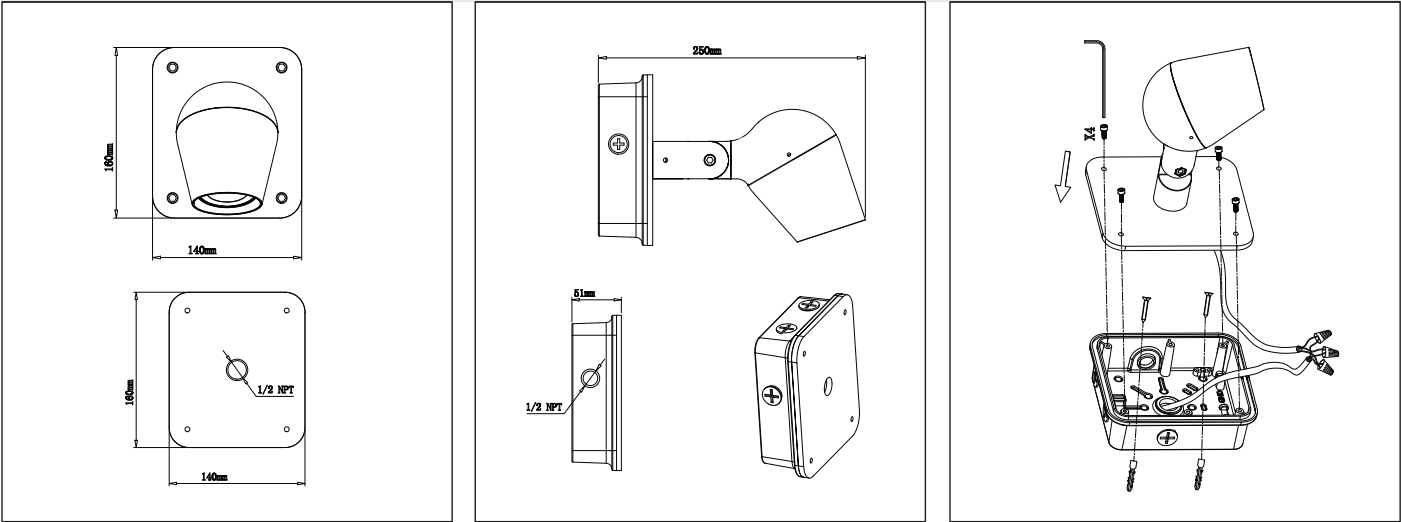

Tree Mount TM

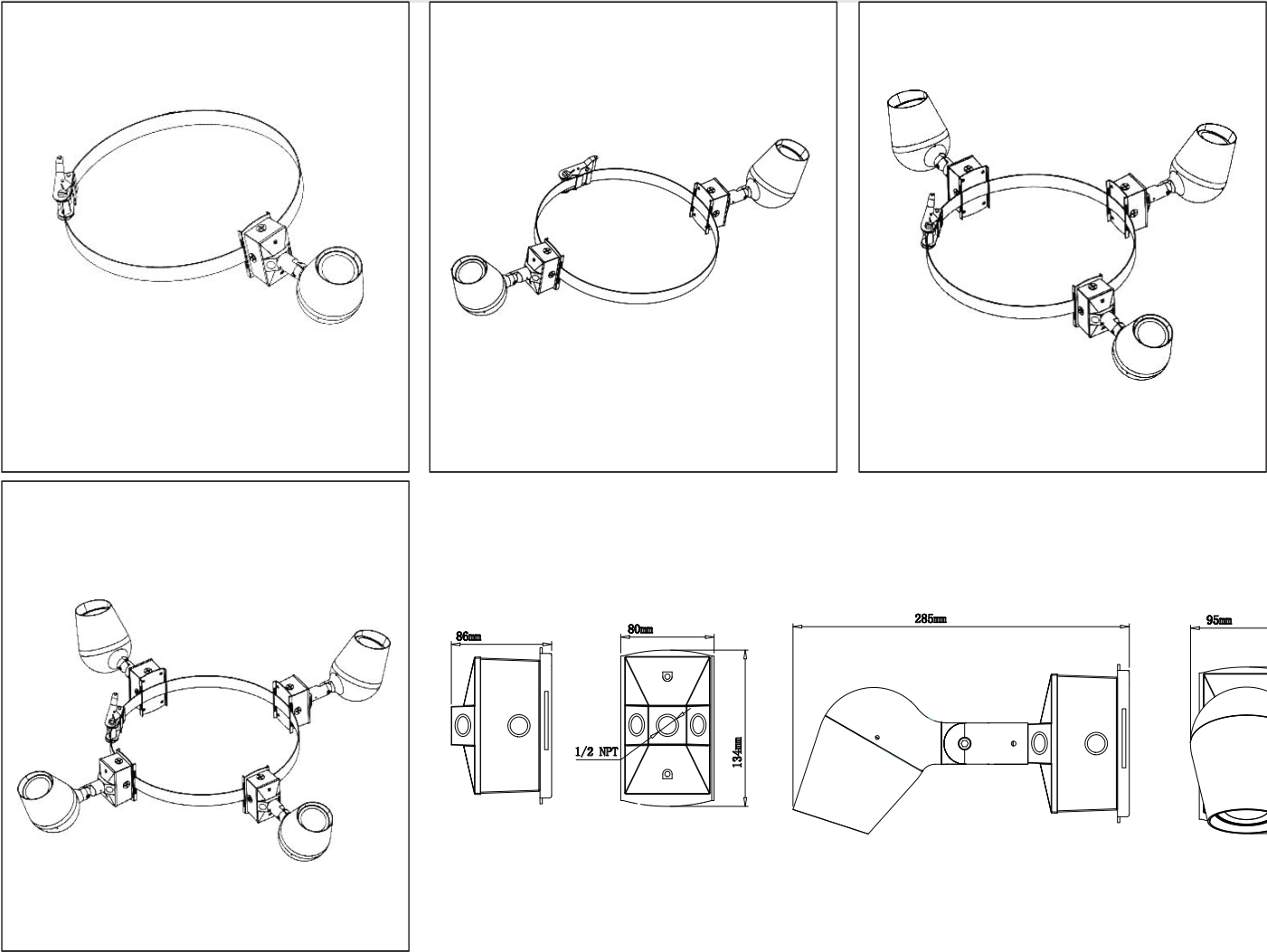

Pole mounted

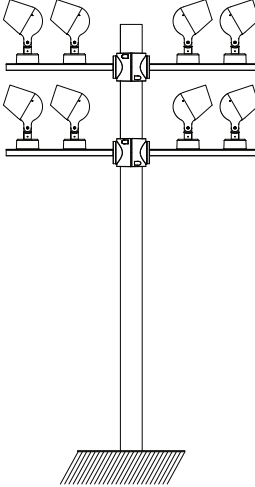
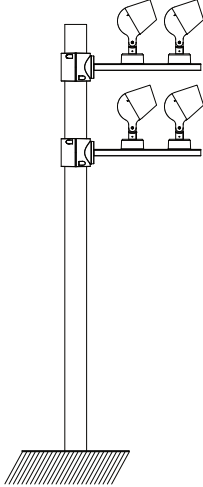
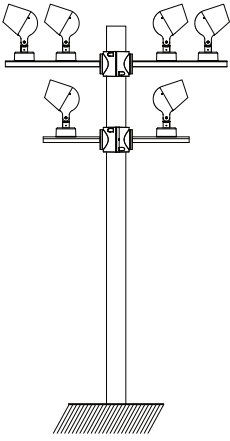
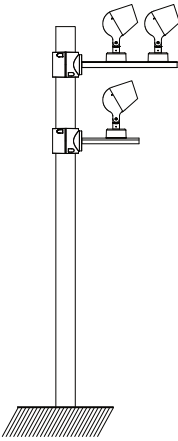
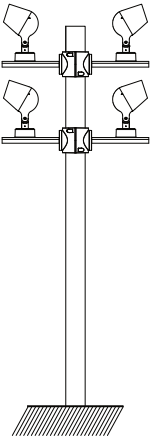
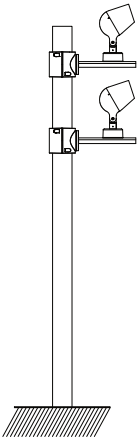
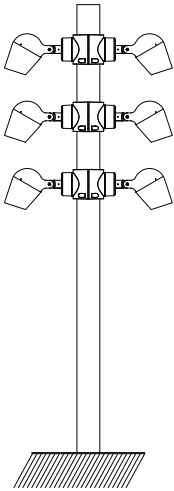
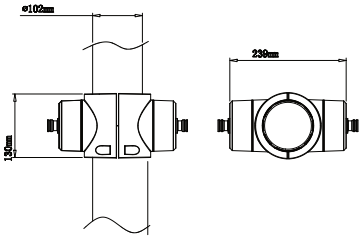
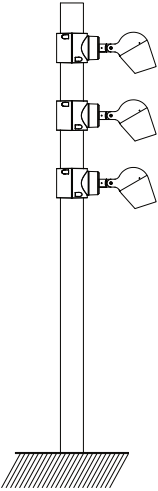
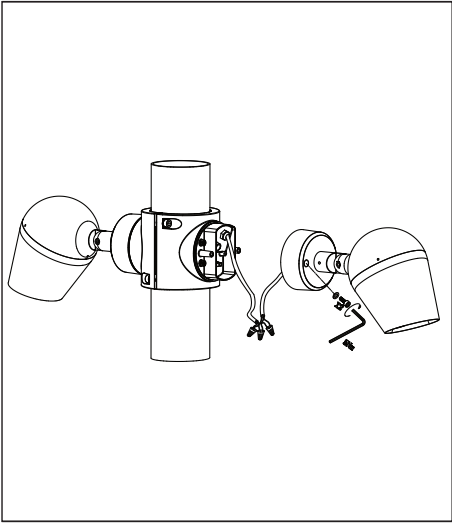
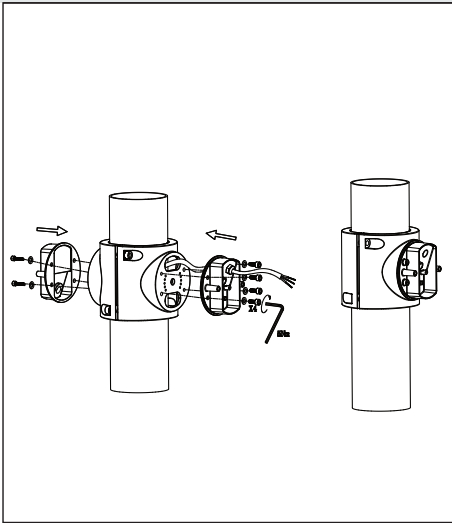
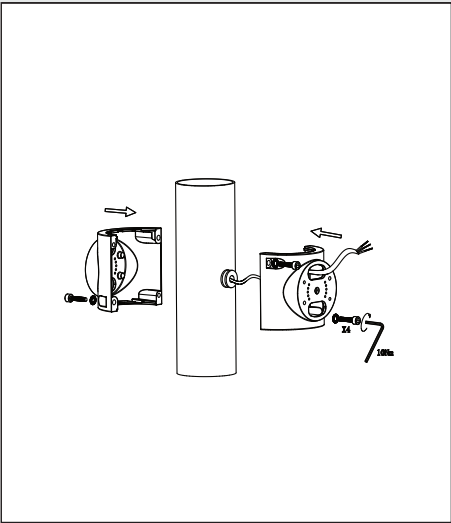
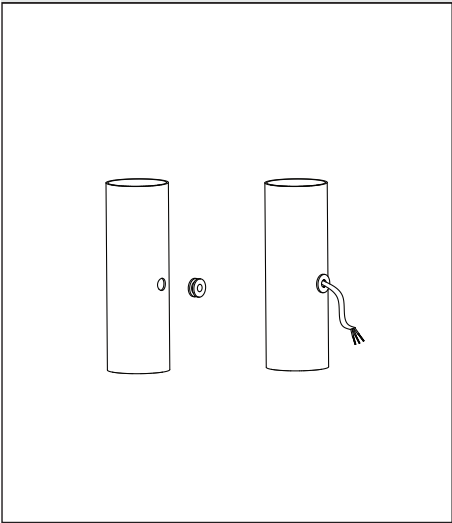

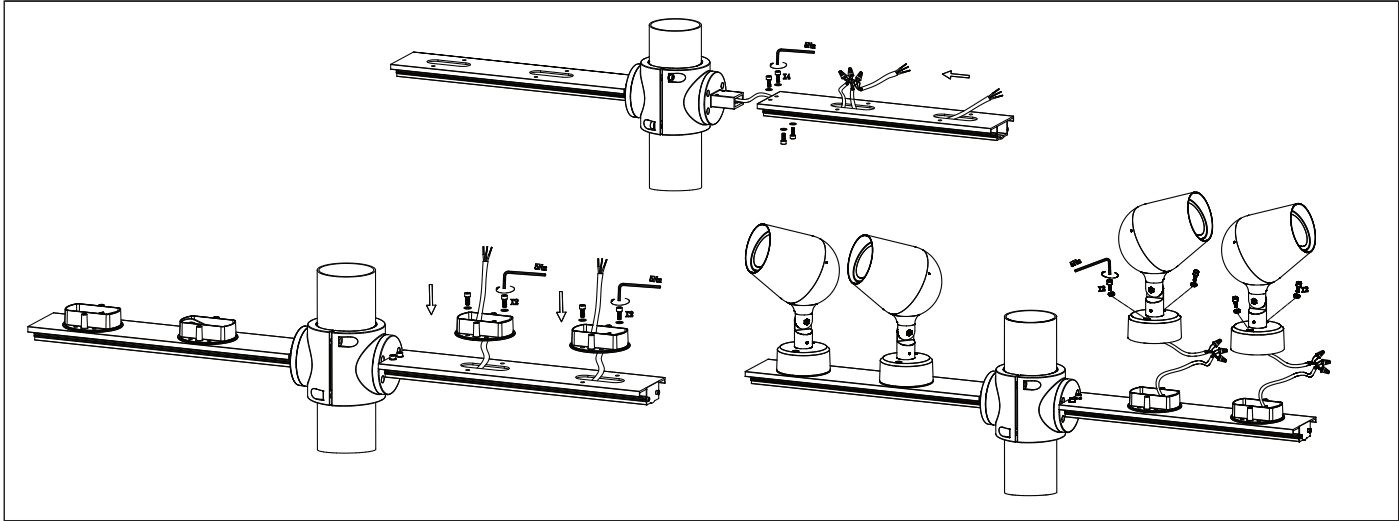
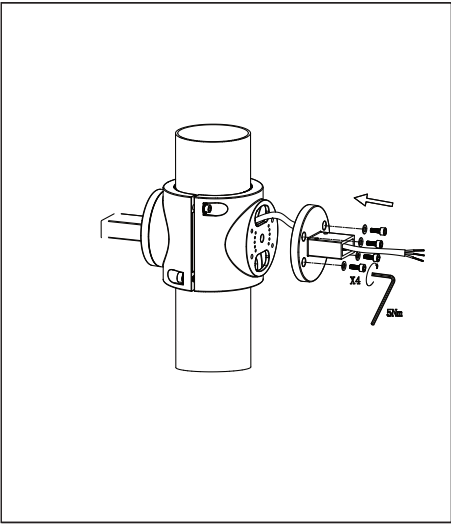
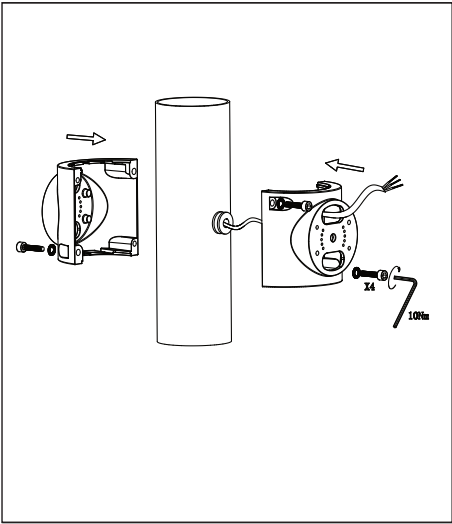
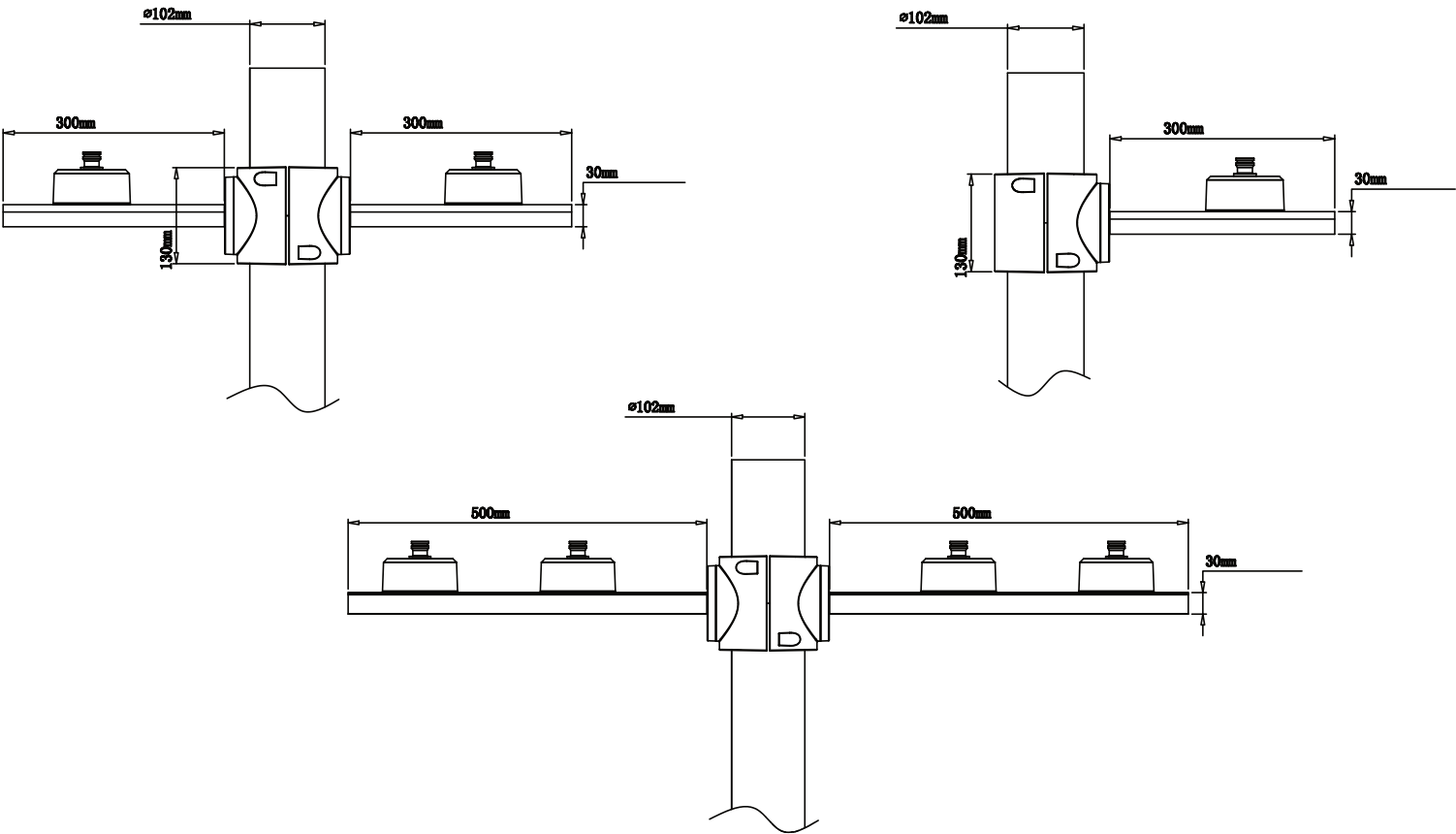

Pole mount single arm

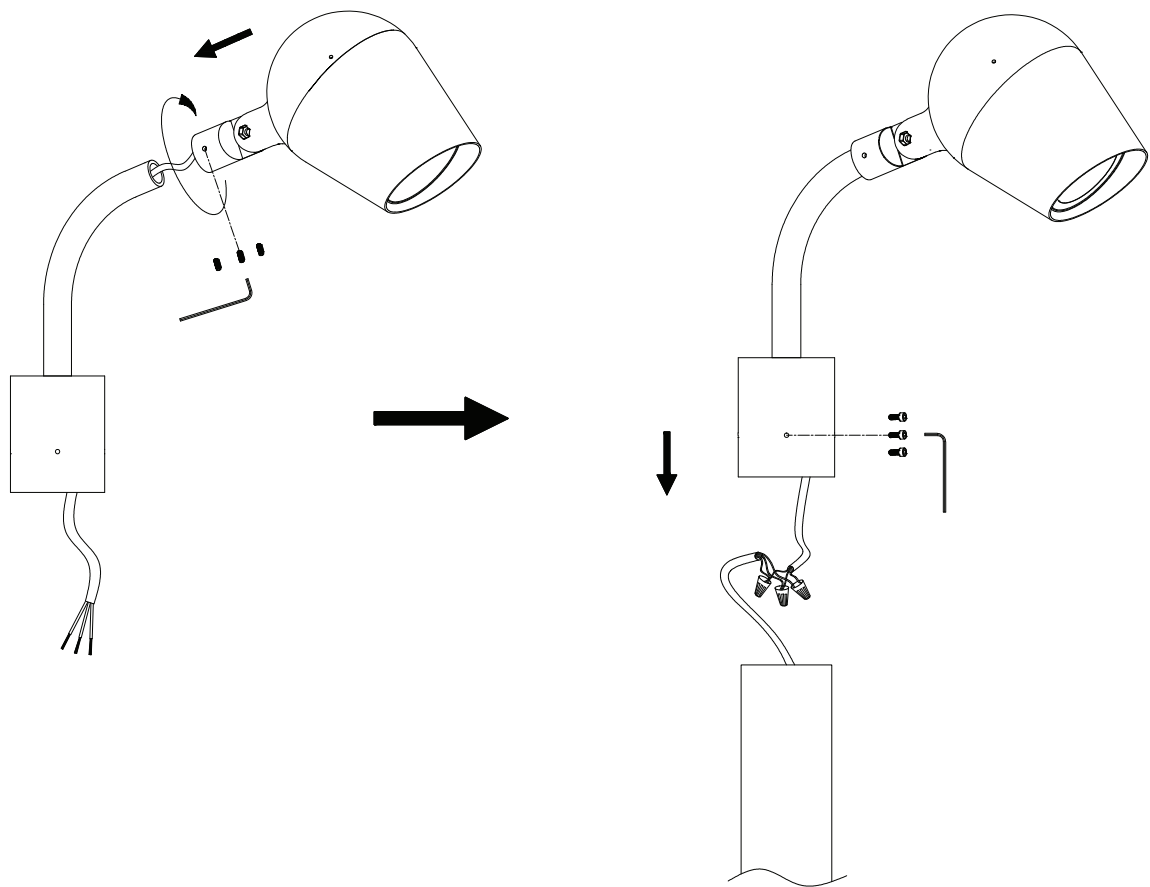
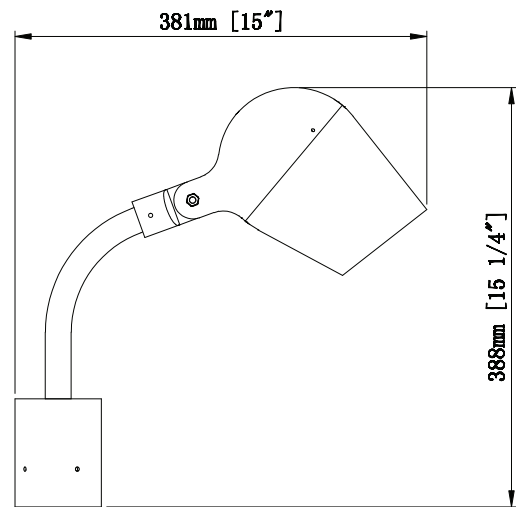
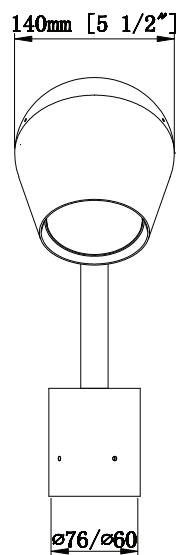

Pole mount double arm

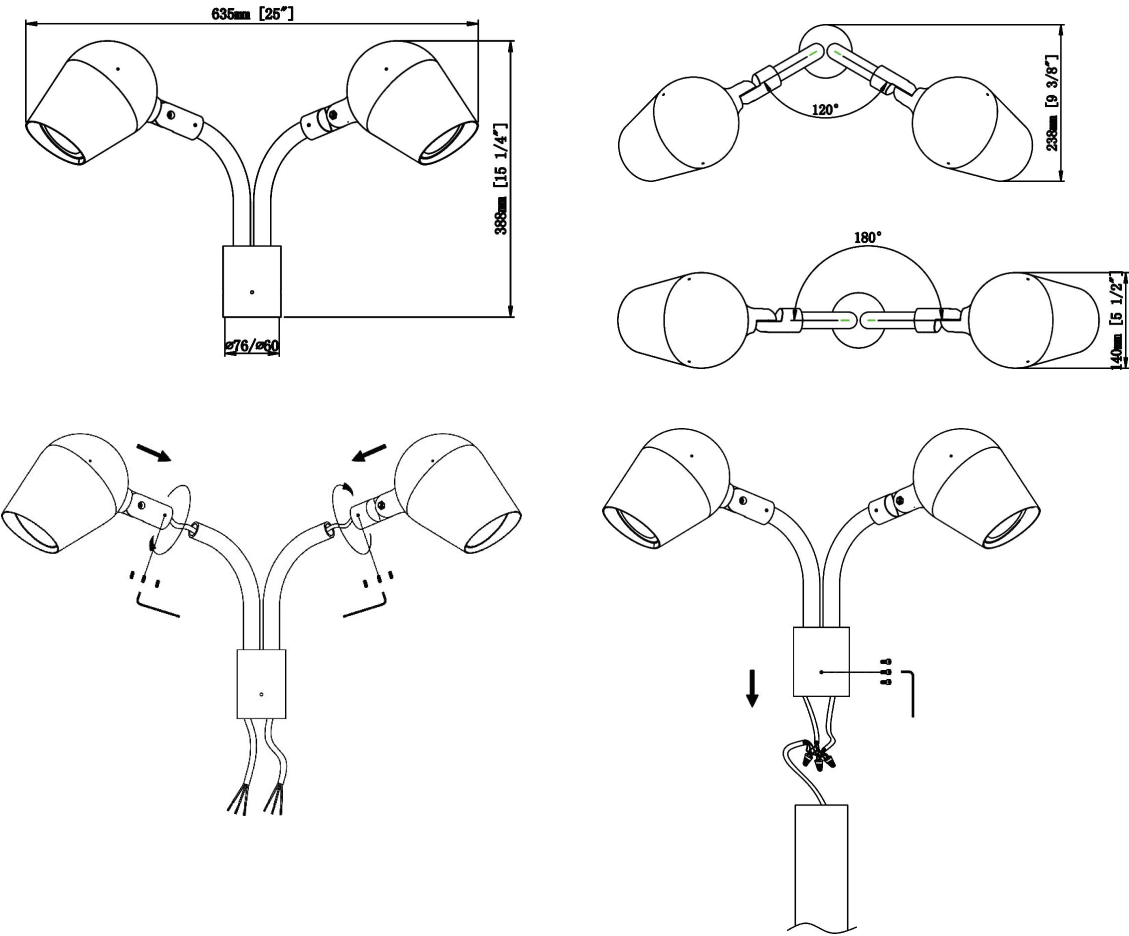

Pole mount triple arm

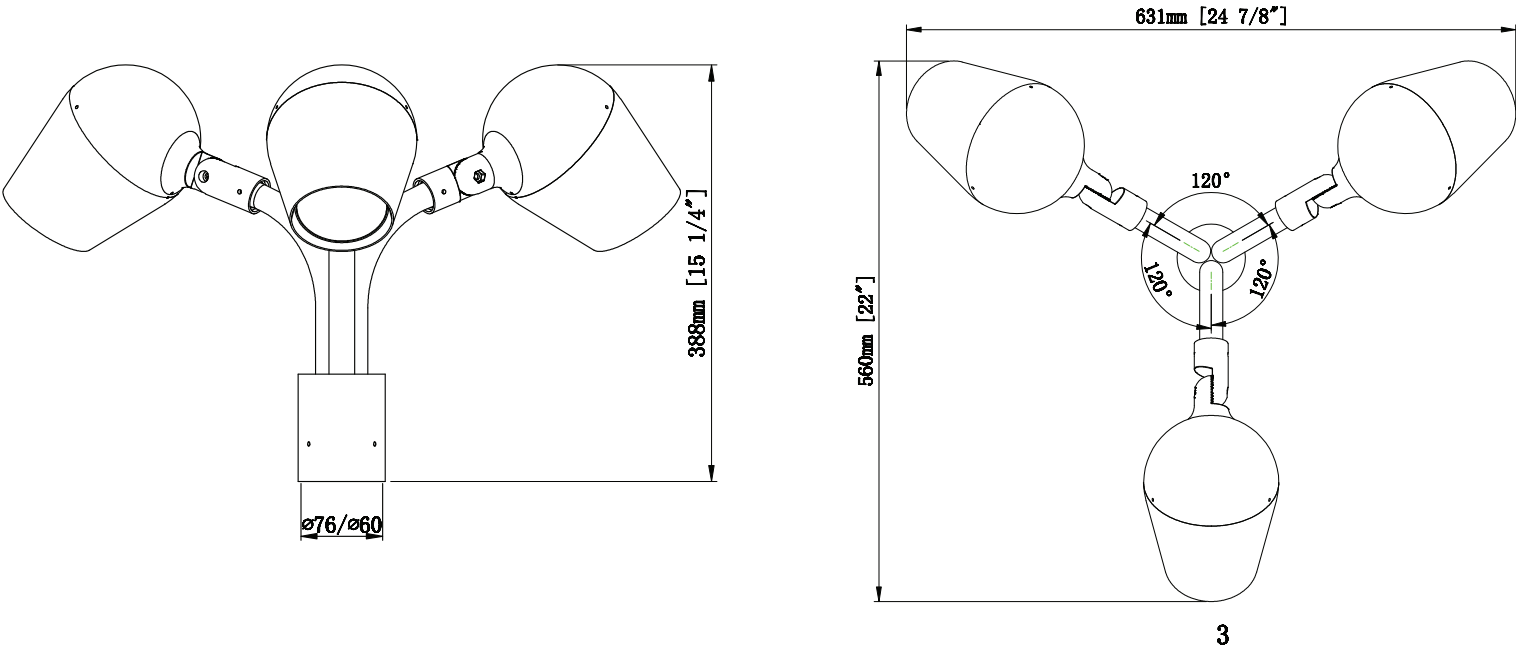

Pole coupler

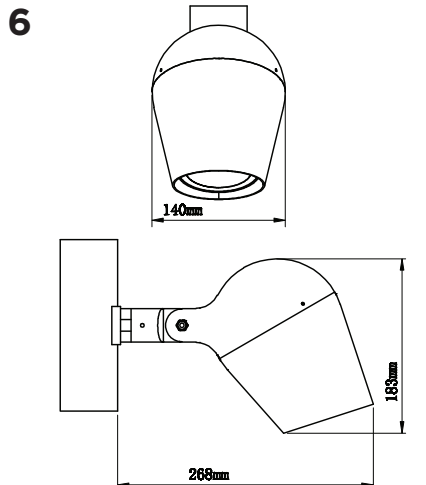
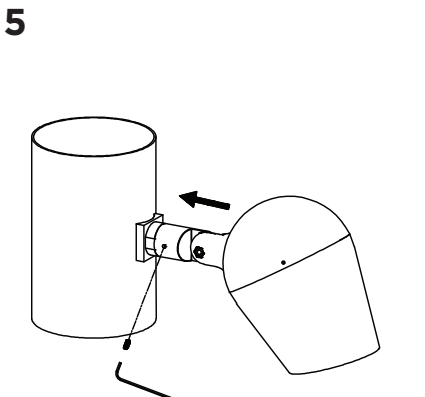
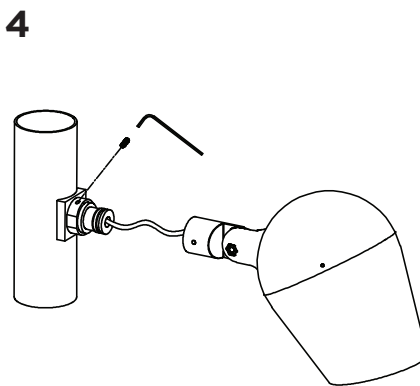
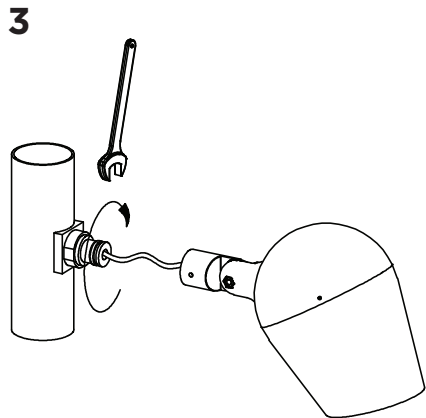
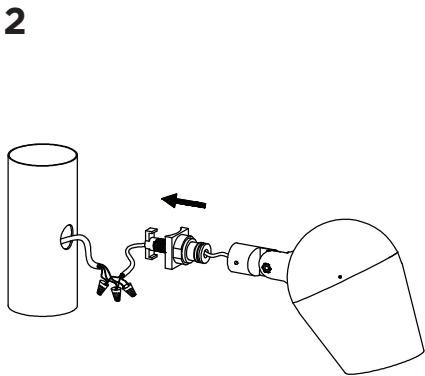
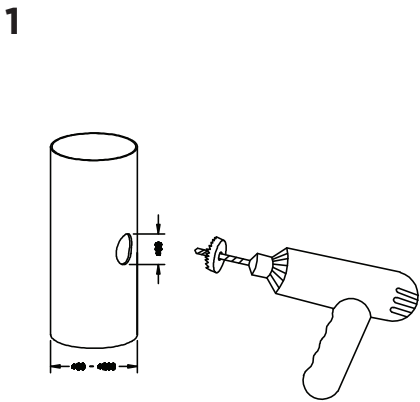

Polar cap installation

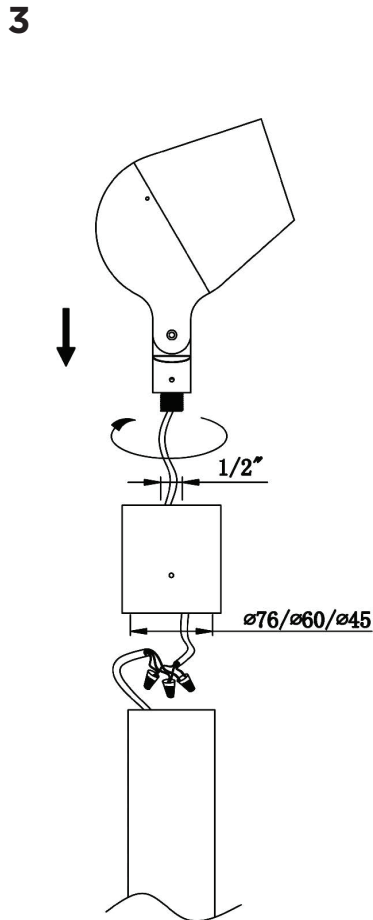
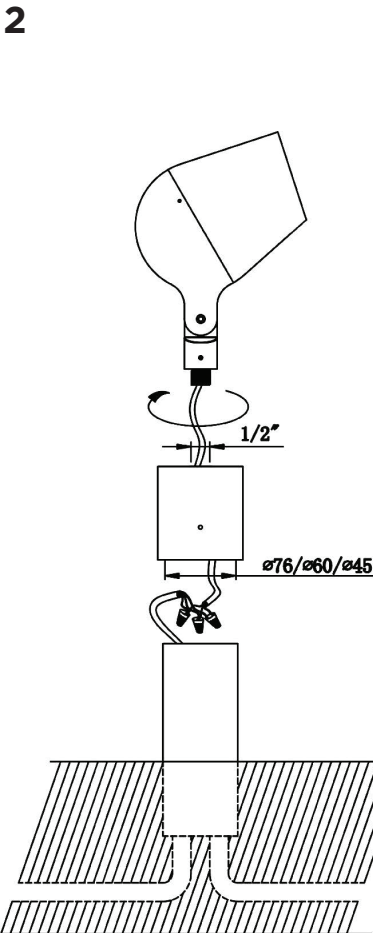
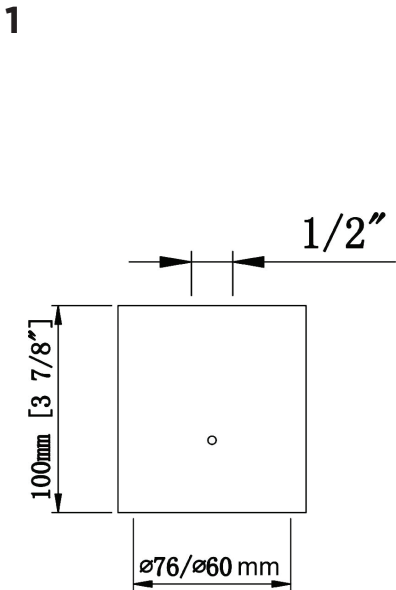

A

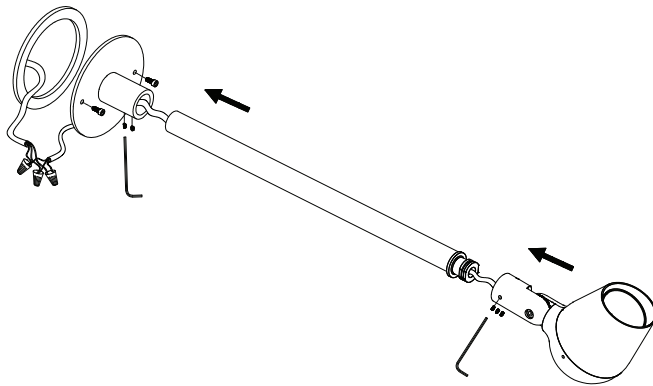

B

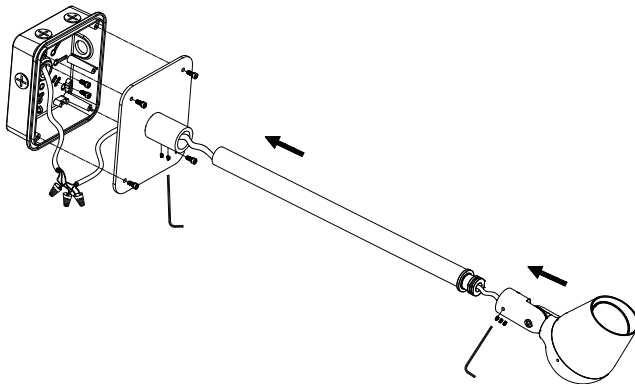

C

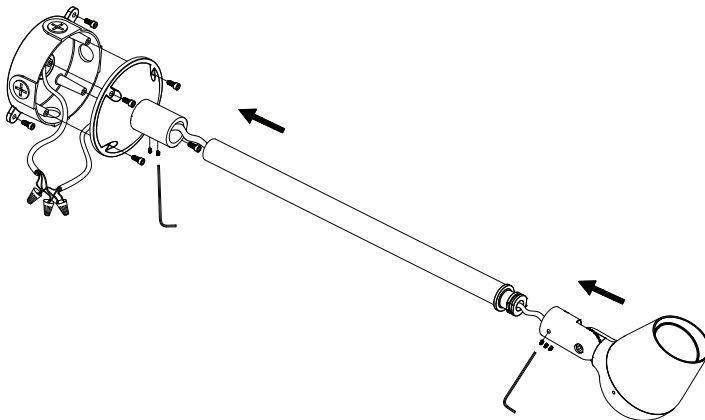

D

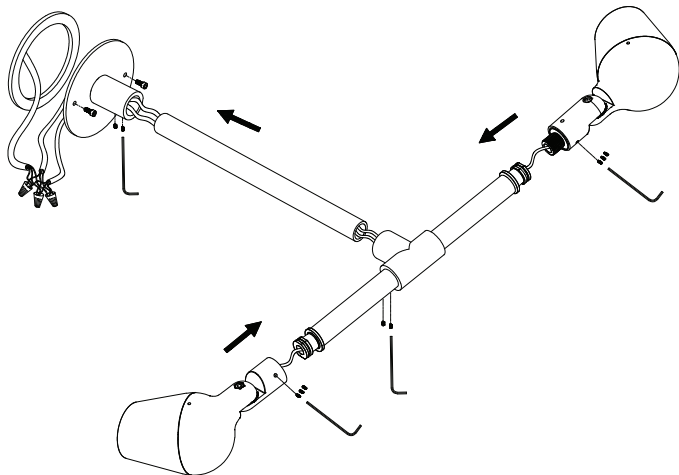

E

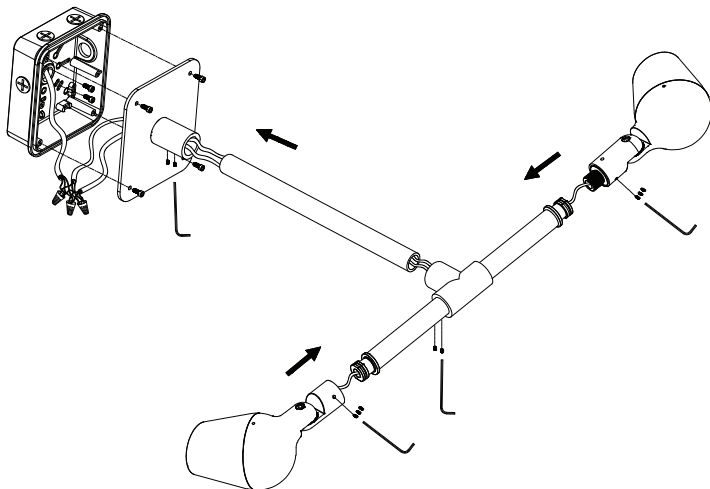

F

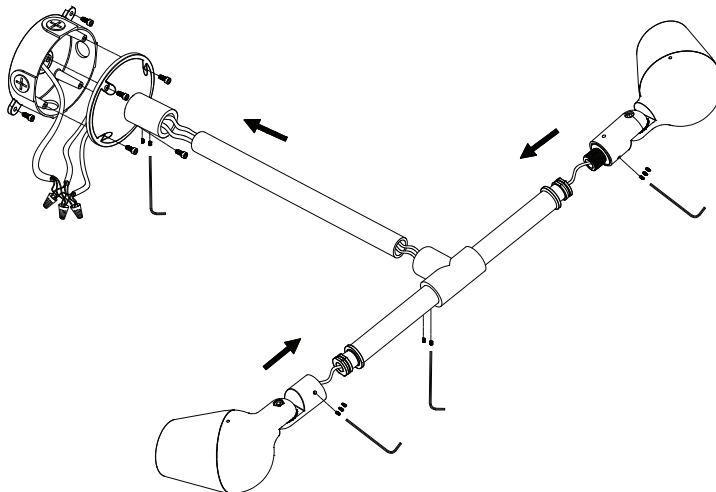

PRODUCT RANGE

	Rated Power(W)	Lumen(lm)	Dimensions(mm)	LED Quantity(pcs)	CCT(K)	Control
VIVID11	3W	270lm	Ø65xH166	COB 1 pcs	Single	Integrated ON-OFF driver, Remote DALI/Dimming driver(36Vdc)
VIVID12	6W	540lm	Ø65xH166	COB 1 pcs	Single	Integrated ON-OFF driver, Remote DALI/Dimming driver(36Vdc)
VIVID13	8W	720lm	Ø65xH166	COB 1 pcs	Single	Integrated ON-OFF driver, Remote DALI/Dimming driver(36Vdc)
VIVID21	10W	900lm	Ø95xH199	COB 1 pcs	Single	Integrated ON-OFF driver, Remote DALI/Dimming driver(36Vdc)
VIVID22	12W	396lm	Ø95xH199	SMD 3 pcs	RGBW	Integrated DMX decoder(24Vdc)
VIVID23	15W	1350lm	Ø95xH199	COB 1 pcs	Single	Integrated ON-OFF driver, Remote DALI/Dimming driver(36Vdc)
VIVID24	20W	1800lm	Ø95xH199	COB 1 pcs	Single	Integrated ON-OFF driver, Remote DALI/Dimming driver(36Vdc)
VIVID31	30W	2700lm	Ø140xH254	COB 1 pcs	Single	Integrated ON-OFF driver and DALI/Dimming driver
VIVID32	40W	3600lm	Ø140xH254	COB 1 pcs	Single	Integrated ON-OFF driver and DALI/Dimming driver
VIVID33	60W	5400lm	Ø140xH254	COB 1 pcs	Single	Integrated ON-OFF driver, Remote DALI/Dimming driver(36Vdc)
VIVID34	24W	792lm	Ø140xH254	SMD 3 pcs	RGBW	Integrated DMX decoder(24Vdc)
VIVID35	36W	1188lm	Ø140xH254	SMD 3 pcs	RGBW	Integrated DMX decoder(24Vdc)
VIVID36	10W	900lm	Ø140xH254	COB 1 pcs	Single	Integrated DALI/Dimming driver
VIVID37	15W	1350lm	Ø140xH254	COB 1 pcs	Single	Integrated DALI/Dimming driver
VIVID38	20W	1800lm	Ø140xH254	COB 1 pcs	Single	Integrated DALI/Dimming driver

*The lumen output may vary depending on the beam angle, and the use of anti-glare accessory.

TECHNICAL DRAWING

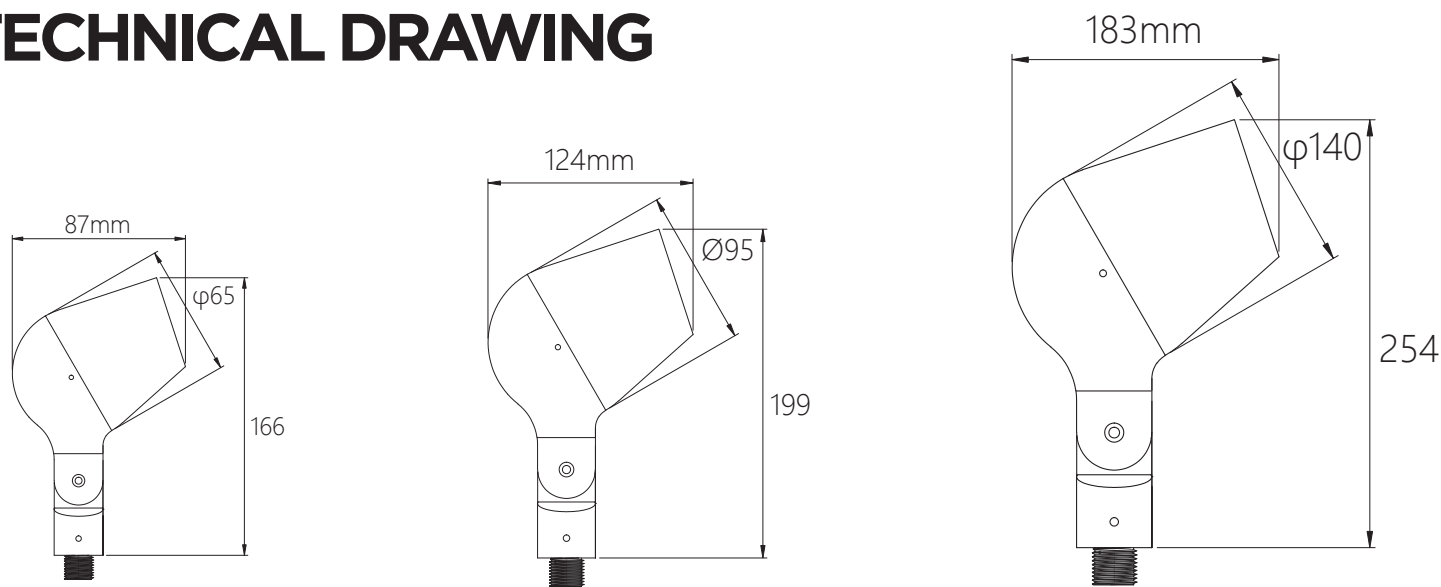

SAFETY INSTRUCTIONS:

- Please read this instruction carefully before the commencement of installation and pass it on to the user of the equipment.
- The installation must be carried out by qualified personnel.
- Disconnect the main voltage, before starting the installation work.
- The light source of this luminaire is not replaceable when the light source reaches the end of its useful life, the entire luminaire is substituted.
- This fixture is not suitable for handheld use. It should be mounted in a fixed and safe place.
- Improper handling of the components or the luminaire itself could damage the correct function of this product, thus avoiding the manufacturer's warranty.
- Luminaire is suitable for outdoor use.
- BEYOND LIGHTING FACTORY is not responsible for the improper use or modifications made to the product.
- In case the external flexible cable or cord of the fixture is damaged, to avoid danger it should only be replaced by the manufacturer or equivalent qualified personnel.
- For possible malfunctions, the defective products must be disassembled and delivered to the manufacturer company without any intervention. During the dismantling of the product, the cable insulation should not be damaged. Also, the cable should not be cut too close to the product. Enough cable should be left to take out the fixture.
- The report, which will be formed as a result of the tests to be made regarding the malfunction, will be shared with the customer, and if necessary, the product will be delivered back to the customer by eliminating the problems according to the warranty.