

KOOT GRAZER 2 SERIES



KOOT GRAZER consists of a range of LED sources to deliver the desired light effect to façades, columns, bridges, monuments, and signs. The LEDs used come in 3 different tones of white, as well as blue, red, green, amber and RGB. Several lenses from 10° to 90° are available.

THERMAL MANAGEMENT

All fixtures are designed to withstand ambient temperatures of at least 50 °C. The LEDs are mounted on metal core PCBs with excellent heat conductivity aluminum coefficient of heat conductivity $\geq 2.0\text{w/mk}$.

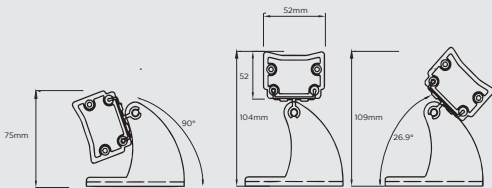

ORDERING CODE

SERIES NAME - PRODUCT RANGE - FINISH - CCT - OPTICS - CONTROL

KOOT GRAZER 2	1	G GREY	30	3000K	10	10°	1	ON-OFF
	2	B BLACK	40	4000K	45	45°	2	DALI
	3		50	5000K	90	90°	3	DMX512
			RGB		1030	10x30°		
			RGBW		2045	20x45°		
					1565	15x65°		
					1545	15x45°		

IP66	220-240V	5 YRS Warranty	36 - 60 WATTS
------	----------	-------------------	------------------

Upon request

1-10V	DALI	DMX	MONO COLOR	RGB	RGBW
-------	------	-----	---------------	-----	------

PHYSICAL

Body	High corrosion resistance die-cast copper-free
Finish	Polyester powder coating with phosphochromating pre-finish Grey/Black (Other colors upon request)
Screws	Stainless Steel 316
Gasket	Silicone rubber
Dimensions	L1000xW52xH109 mm

OPTICAL

Diffuser	Tempered Glass
Beam Angle	10°,45°,90°,10x30°,20x45°,15x65°,15x45°
Bracket	Adjustable
CRI	>80

ELECTRICAL

Light source	LED
Lumen	80 lm/W
CCT	3000K, 4000K, 5000K, RGB, RGBW
Driver	24Vdc remote driver to be ordered separately
Ambient Temp.	-25°C ~ 50°C
Ambient Humidity	10% ~ 90%
Light source Life	50,000 h

Range	Power (W)	Lumen (lm)
KOOT GRAZER 2.1	36W	2880lm
KOOT GRAZER 2.2	48W	3840lm
KOOT GRAZER 2.3	60W	4800lm