

HIGH BAY GLOW SERIES

INSTALLATION INSTRUCTION



IP65

IK08

220-240V

5 YRS
Warranty

60 - 200
WATTS

LOW
GLARE

UGR
<19

Upon request

1-10V

PHYSICAL

| | |
|--------|----------------------------------|
| Body | Aluminum Alloy |
| Finish | Powder Coating / Black (RAL9017) |

OPTICAL

| | |
|-------|----|
| Optic | PC |
|-------|----|

ELECTRICAL

| | |
|------------------|--|
| Light source | LED |
| CRI | >70 (Ra80 optional) |
| CCT | 3000K,4000K,5000K |
| Driver | Electronic included 50-60Hz 220-240VAC Non-Dimmable Driver 1-10V dimming or Microwave motion sensor, PIR sensor |
| Ambient Temp. | -30°C - 50°C |
| Ambient Humidity | 10% - 90% |

HIGH BAY GLOW A | 160lm/W

| | Rated Power(W) | Dimensions (mm) | Lumen (lm) |
|---------------------|----------------|-----------------|------------|
| HIGH BAY GLOW A 1.1 | 60W | Ø250xH164 | 9600 lm |
| HIGH BAY GLOW A 1.2 | 100W | Ø250xH164 | 16000 lm |
| HIGH BAY GLOW A 1.3 | 120W | Ø250xH164 | 19200 lm |
| HIGH BAY GLOW A 2 | 150W | Ø261xH169 | 24000 lm |
| HIGH BAY GLOW A 3 | 200W | Ø301xH170 | 32000 lm |

HIGH BAY GLOW B | 200lm/W

| | Rated Power(W) | Dimensions (mm) | Lumen (lm) |
|---------------------|----------------|-----------------|------------|
| HIGH BAY GLOW B 1.1 | 60W | Ø250xH164 | 12000 lm |
| HIGH BAY GLOW B 1.2 | 100W | Ø250xH164 | 20000 lm |
| HIGH BAY GLOW B 1.3 | 120W | Ø250xH164 | 24000 lm |
| HIGH BAY GLOW B 2 | 150W | Ø261xH169 | 30000 lm |
| HIGH BAY GLOW B 3 | 200W | Ø301xH170 | 40000 lm |

HIGH BAY GLOW C | 210lm/W

| | Rated Power(W) | Dimensions (mm) | Lumen (lm) |
|---------------------|----------------|-----------------|------------|
| HIGH BAY GLOW C 1.1 | 60W | Ø250xH164 | 12600 lm |
| HIGH BAY GLOW C 1.2 | 100W | Ø250xH164 | 21000 lm |
| HIGH BAY GLOW C 1.3 | 120W | Ø250xH164 | 25200 lm |
| HIGH BAY GLOW C 2 | 150W | Ø261xH169 | 31500 lm |
| HIGH BAY GLOW C 3 | 200W | Ø301xH170 | 42000 lm |

ACCESSORIES



Motion sensorPIR sensorPC LENSPC reflector coverPC reflectorOptic lensSafety chainPC reflectorAluminum ReflectorCeiling mount bracket±90° Adjustable bracketEmergency kit box

SENSOR MOUNT

1 Option 1: 3 PIN sensor

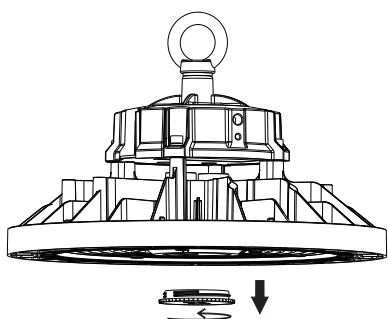

2

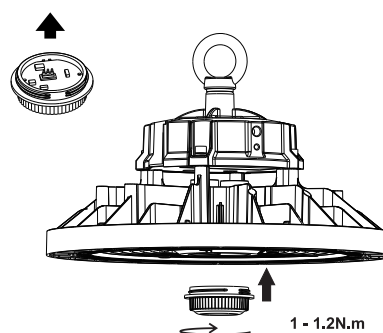

1 Option 2: 1 PIN sensor

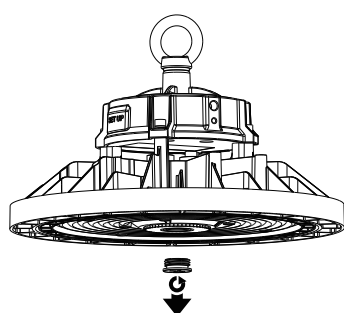

2

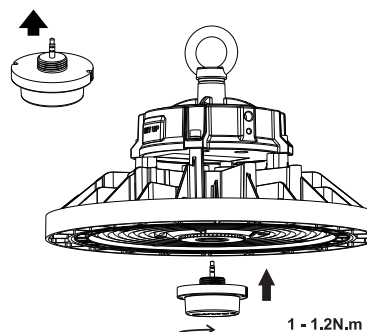

All sizes are in millimeters.

SUSPENSION MOUNT

1

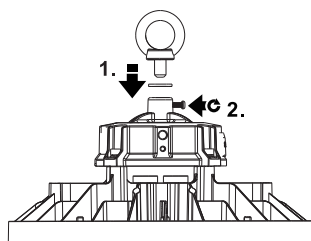

Make sure the screws are tightened.



2

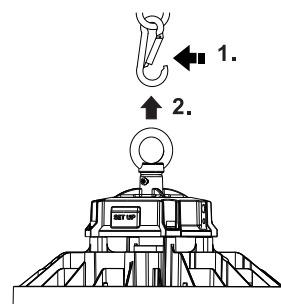

Recommended hook size: Ø6x60mm/Ø8x80mm

CEILING MOUNT

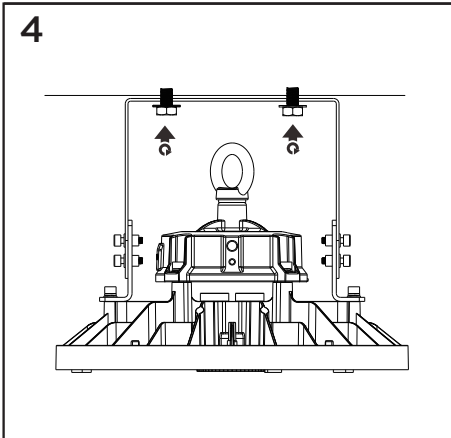
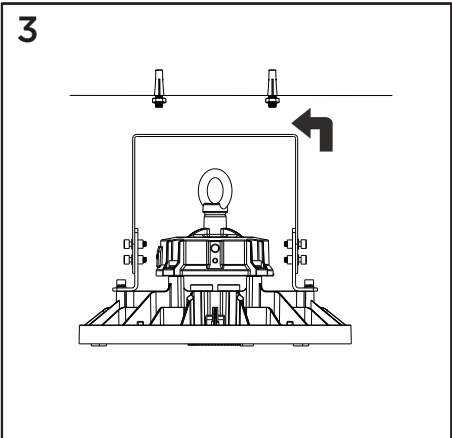
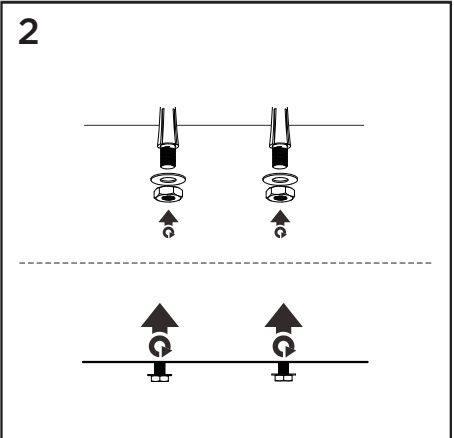
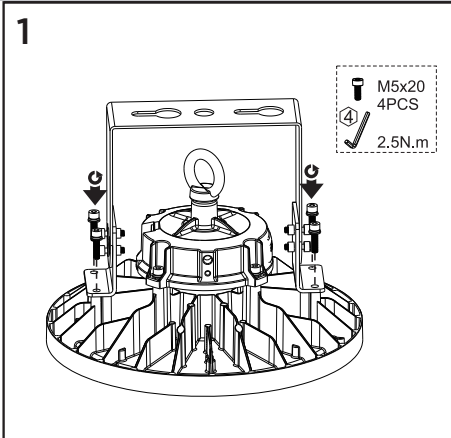
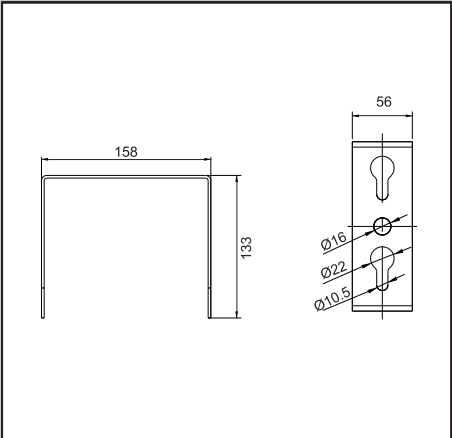

PC Reflectors

60/100/120/150W

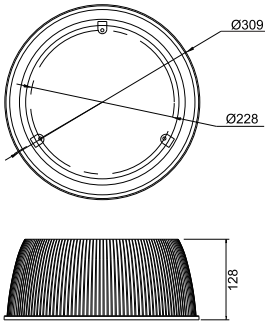

200W

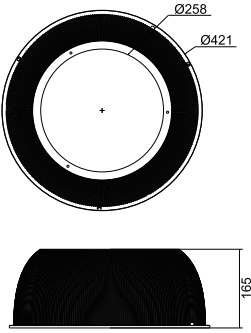

PC Reflectors

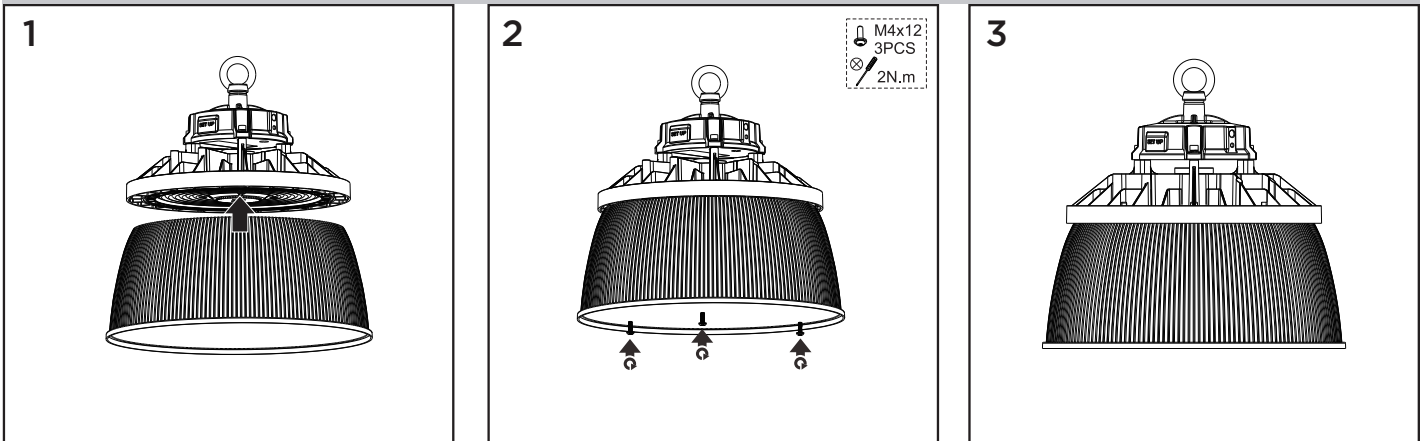

Aluminum Reflectors

60/100/120/150W

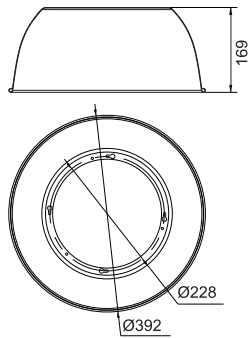

200W

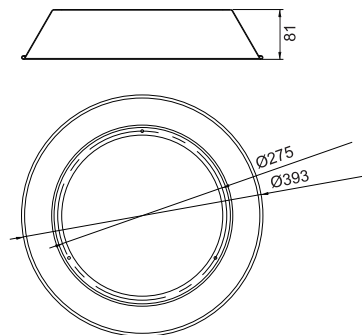

Aluminum Reflectors

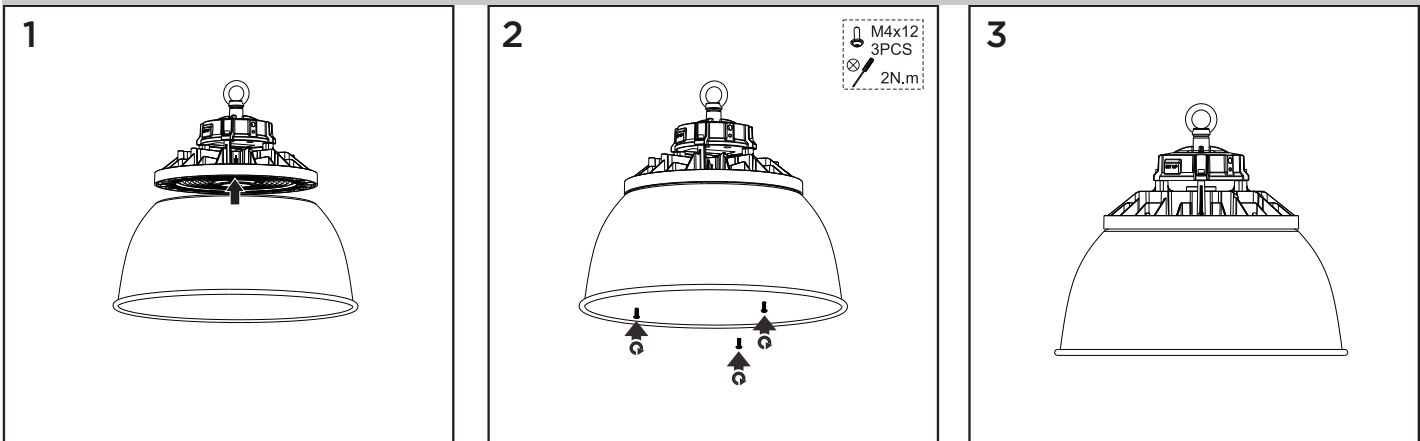

AC cords

| | | | |
|---|--------------|--|-------|
| L | brown | | black |
| N | blue | | white |
| ⊕ | yellow/green | | green |

DIM cords

Note: color for dim cords subject to the cable label on luminaire



DO NOT WIRE DIM CORD TO HIGH VOLTAGE,
OR DIM FUNCTION WILL FAIL.

- Don't wite dim cord to high voltage,avoid dim function fail.
- Installation height recommends to be above 4 meters and indoor application.
- We highly suggest users to maintain and clean dust from the luminaire regularly, to keep its lifespan.
- If the external flexible cable or cord of this luminaire is damaged, it shall be exclusively replaced by the manufacturer or his service agent or a similar qualified person in order to avoid a hazard.

TECHNICAL DRAWING

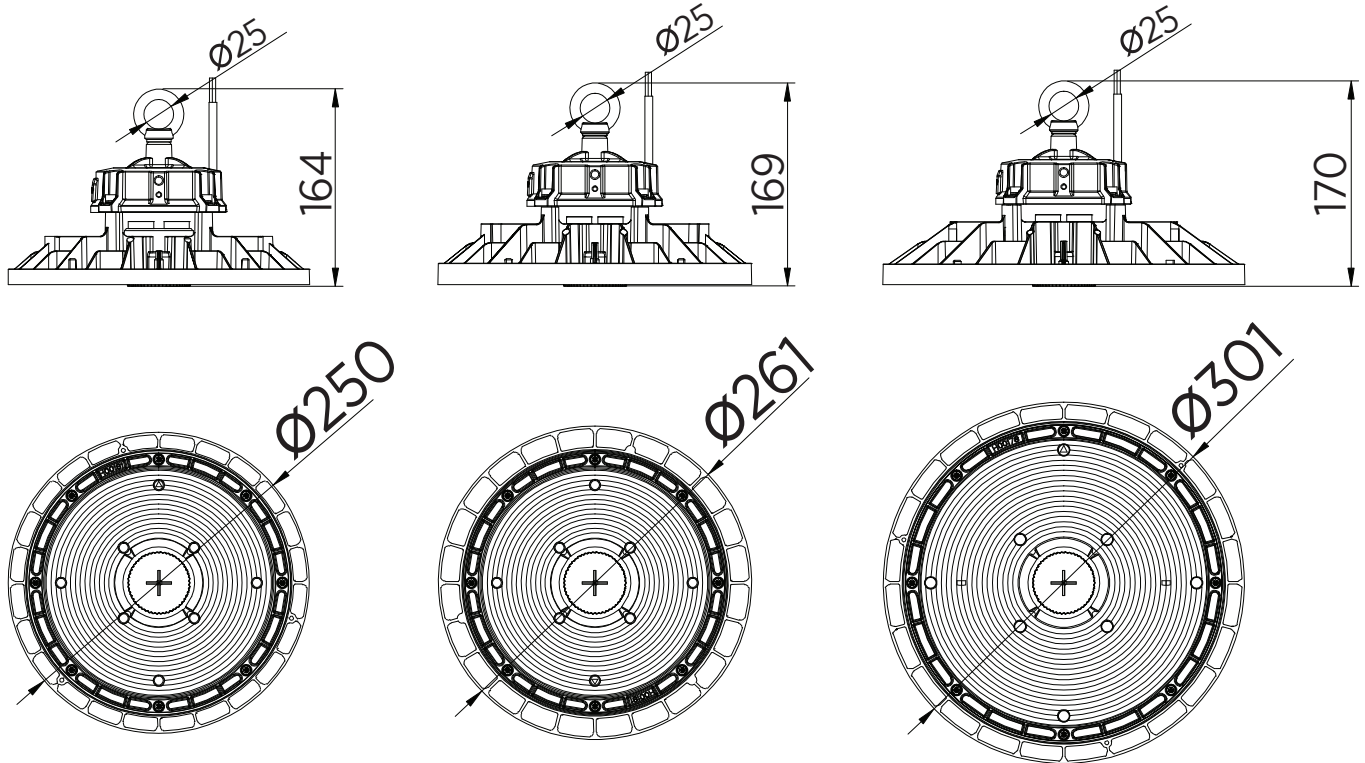

SAFETY INSTRUCTIONS:

- Please read this instruction carefully before the commencement of installation and pass it on to the user of the equipment.
- The installation must be carried out by qualified personnel.
- Disconnect the main voltage, before starting the installation work.
- The light source of this luminaire is not replaceable when the light source reaches the end of its useful life, the entire luminaire is substituted.
- This fixture is not suitable for handheld use. It should be mounted in a fixed and safe place.
- Improper handling of the components or the luminaire itself could damage the correct function of this product, thus avoiding the manufacturer's warranty.
- Luminaire is suitable for indoor use.
- BEYOND LIGHTING FACTORY is not responsible for the improper use or modifications made to the product.
- In case the external flexible cable or cord of the fixture is damaged, to avoid danger it should only be replaced by the manufacturer or equivalent qualified personnel.
- For possible malfunctions, the defective products must be disassembled and delivered to the manufacturer company without any intervention. During the dismantling of the product, the cable insulation should not be damaged. Also, the cable should not be cut too close to the product. Enough cable should be left to take out the fixture.
- The report, which will be formed as a result of the tests to be made regarding the malfunction, will be shared with the customer, and if necessary, the product will be delivered back to the customer by eliminating the problems according to the warranty.